

## Instructions on How to Change the Battery in the I-9 Series of Units

Or go to [CHI.US](http://CHI.US) and look under RESOURCES to see the **How-To video**



1. Use a small **Phillips head/tipped screwdriver** to remove the screw in the battery door.



2. Once you have removed the screw, remove the battery door by sliding it backwards. *If need be, you can use a **small flat head** screwdriver and leverage the battery door by wedging it in an upward and downward motion. There's a small opening in the upper right-hand corner of the door panel to wedge the screwdriver.*



3. Grasp the **red & black** leading wires that go down into the internal circuit board of the unit and pull **straight up**. **Pro Tip: It's important to pull straight up and avoid the white charging head from getting caught up on the units internal housing.** Make note of how you removed it and the shape of the charging head that went into the charging ports internal circuit board.

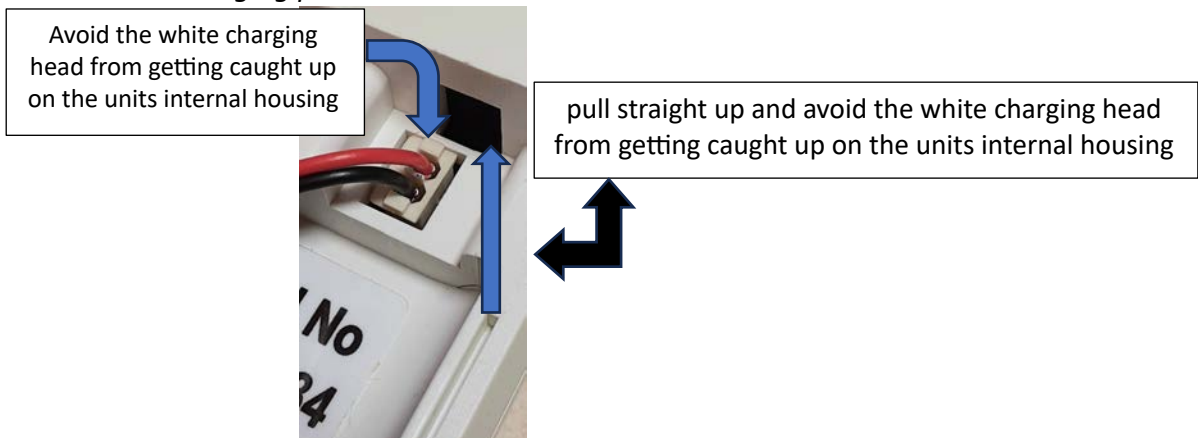

4. Insert the new battery the same way that you removed the old battery. You will notice that there is a side with a grooved slot with a shape of a roof on a house on the white charging head. Insert this charging head back into the internal circuit board so that the shapes match each other.



5. Use your screwdriver to push the **red & black** battery wiring charging head back down into the internal circuit board charging port. The RED wire is on top, facing towards the top of the unit. **\*Make SURE that you hear or feel a click and that your unit beeps.** \*Your unit might beep and work, and the lights may come on, **but it will not take a proper charge nor will it work properly if the battery charging head is not pushed ALL the way down.**

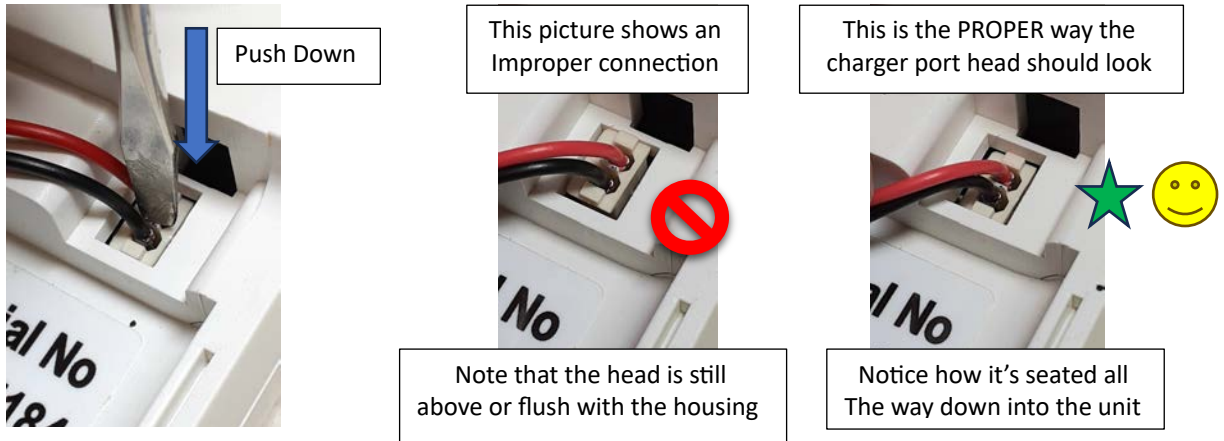

6. Slide your battery cover back on and put the screw in.

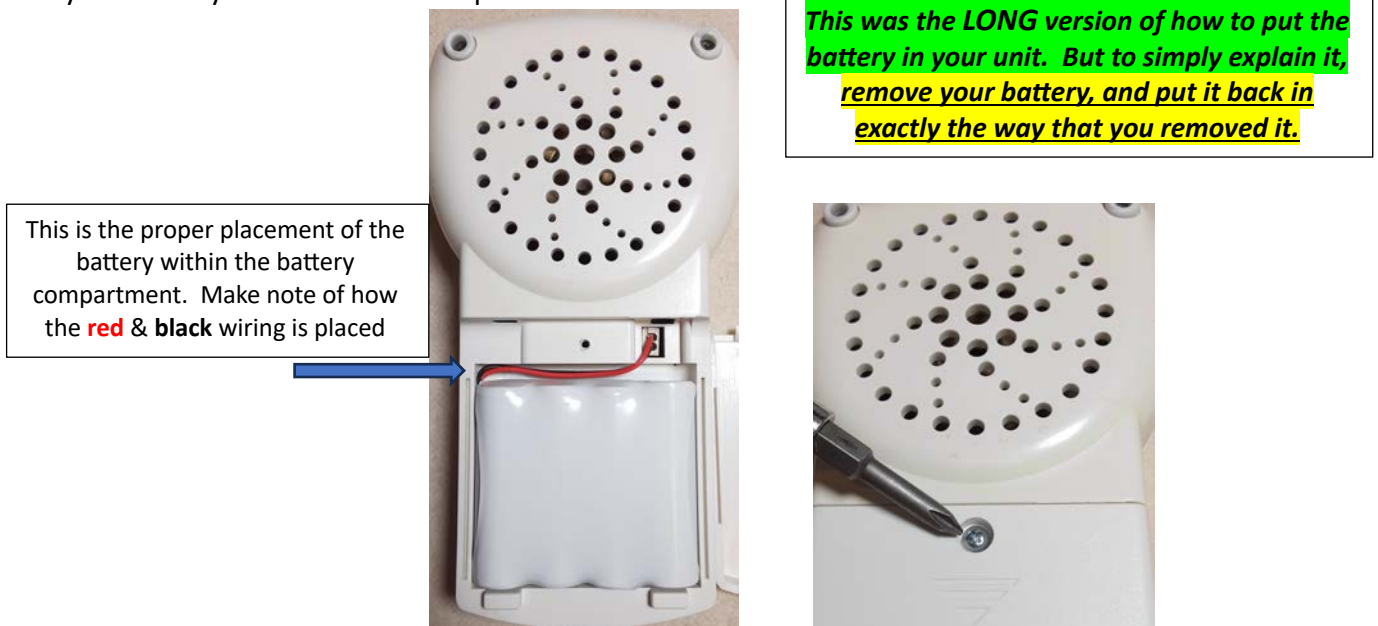

*Enjoy your Infratonic*